

**Temporary Striping Legend**

- (W-2) 8" White Line  
Shown Thus:
- (DYN) (2) 4" Yellow Lines Narrow Double  
Shown Thus:
- (S) Stop Line  
Shown Thus:
- (CW) Crosswalk Line  
Shown Thus:
- (WB) 4" White Broken Line  
Shown Thus:
- (W) 4" White Line  
Shown Thus:
- (E-LA) Elongated Left Turn Arrow  
Shown Thus:

- (B) EXTG. SIGNAL
- UNDER TRAFFIC
- UNDER CONSTRUCTION
- UNCONSTRUCTED BRIDGE SECTION
- ..... TEMP. PLASTIC DRUMS ON 10' MAX. SPACINGS
- 28" TUBULAR MARKERS ON 40' MAX. SPACINGS

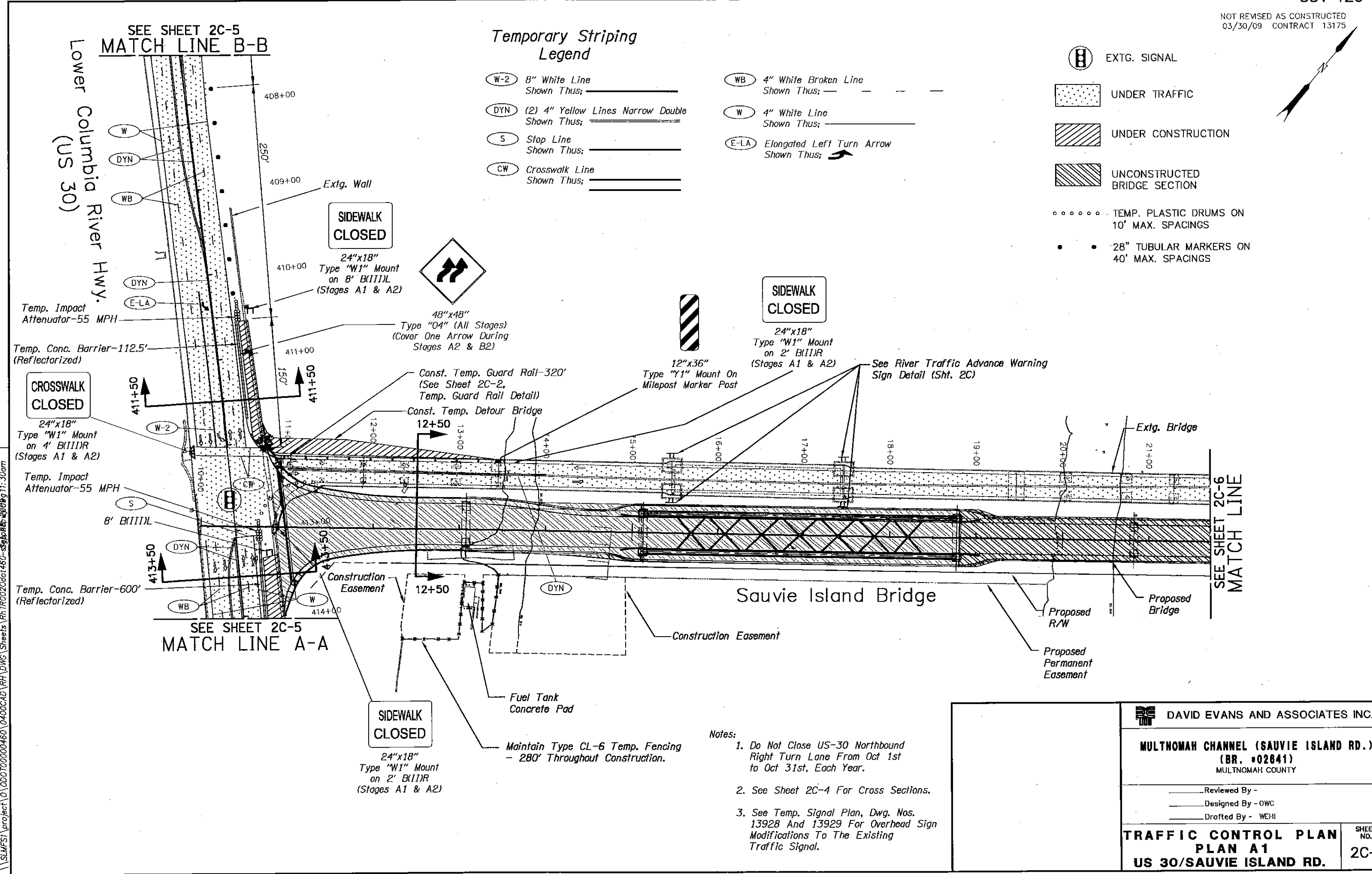

- Notes:**
1. Do Not Close US-30 Northbound Right Turn Lane From Oct 1st to Oct 31st, Each Year.
  2. See Sheet 2C-4 For Cross Sections.
  3. See Temp. Signal Plan, Dwg. Nos. 13928 And 13929 For Overhead Sign Modifications To The Existing Traffic Signal.

DAVID EVANS AND ASSOCIATES INC.	
<b>MULTNOMAH CHANNEL (SAUVIE ISLAND RD.)</b> (BR. #02641) MULTNOMAH COUNTY	
Reviewed By -	_____
Designed By - OWC	_____
Drafted By - WEHI	_____
<b>TRAFFIC CONTROL PLAN</b> <b>PLAN A1</b> <b>US 30/SAUVIE ISLAND RD.</b>	
SHEET NO.	2C-3

\\SLM\FST\project\0\050700000460\04000CAD\RH\DWG\Sheets\RH\TR0020000460-sig\p1a1.dwg 11:30am

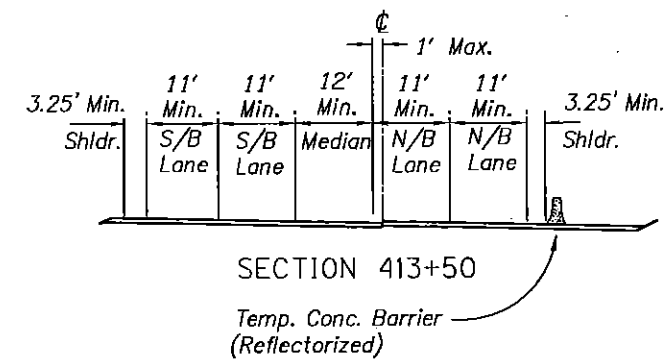
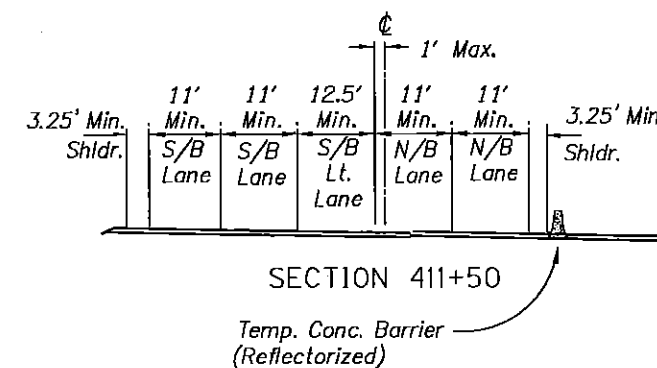
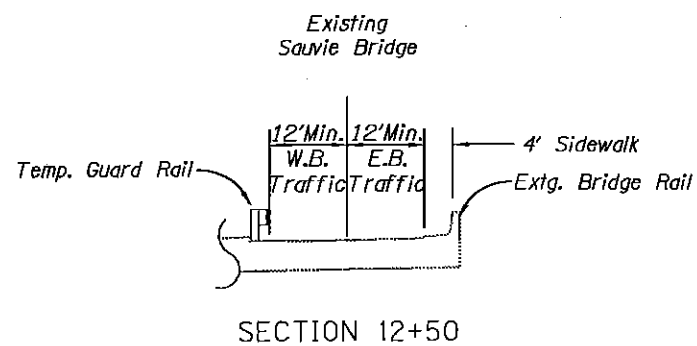

Note:  
1. See Sheet 2C-3 For The Plan View

\\SLMFS1\project\0\000700000460\04000CAD\PH\DWG\Sheets\RH\TR0020dot460-s\eggs\B\B\0909.ctb Huggam

 DAVID EVANS AND ASSOCIATES INC.	
MULTNOMAH CHANNEL (SAUVIE ISLAND RD.) (BR. #02641) MULTNOMAH COUNTY	
Reviewed By - _____ Designed By - OWC Drafted By - WEHI	
TRAFFIC CONTROL PLAN A1 US 30/SAUVIE ISLAND RD. SECTIONS	SHEET NO. 2C-4

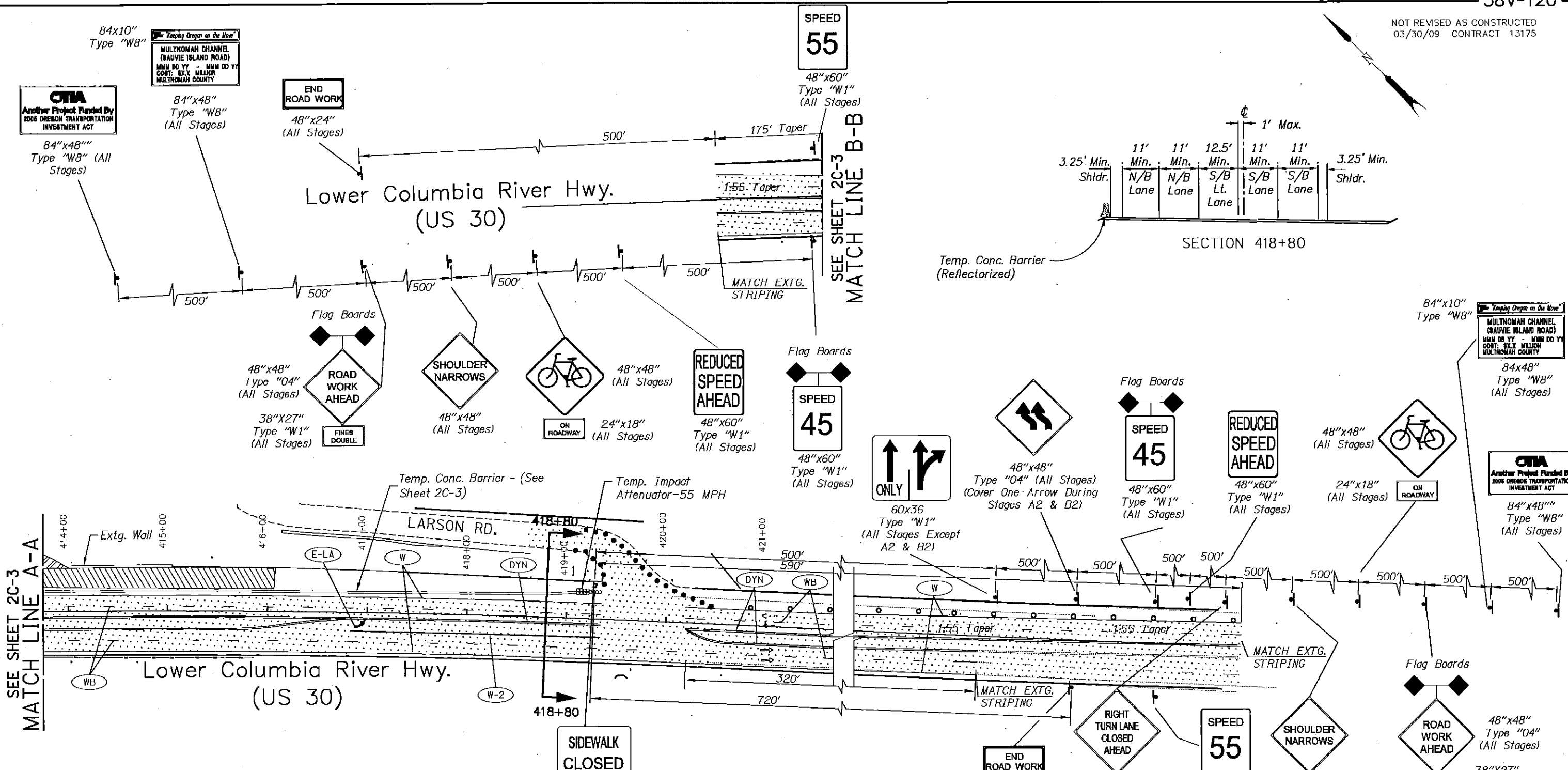

- Temporary Striping Legend**
- (W-2) 8" White Line  
Shown Thus: \_\_\_\_\_
  - (DYN) (2) 4" Yellow Lines Narrow Double  
Shown Thus: \_\_\_\_\_
  - (WB) 4" White Broken Line  
Shown Thus: - - - - -
  - (W) 4" White Line  
Shown Thus: \_\_\_\_\_
  - (E-LA) Elongated Left Turn Arrow  
Shown Thus: ↗

- 28" TEMP. TUBULAR MARKERS ON 10' MAX. SPACINGS
- ○ TEMP. PLASTIC DRUMS ON 40' MAX. SPACINGS

**Notes:**  
1. Do Not Close US-30 Northbound Right Turn Lane From Oct 1st to Oct 31st, 2006 And 2007.

**DAVID EVANS AND ASSOCIATES INC.**

**MULTNOMAH CHANNEL (SAUVIE ISLAND RD.) (BR. #02641)**  
MULTNOMAH COUNTY

Reviewed By - \_\_\_\_\_  
Designed By - OWC  
Drafted By - WEH

**TRAFFIC CONTROL PLAN A1**

SHEET NO. **2C-5**

I:\S\MSF\Project\00000000450\040000450\040000450\Rh\RD020dot460-sgppp\B8\0903.dwg 31am

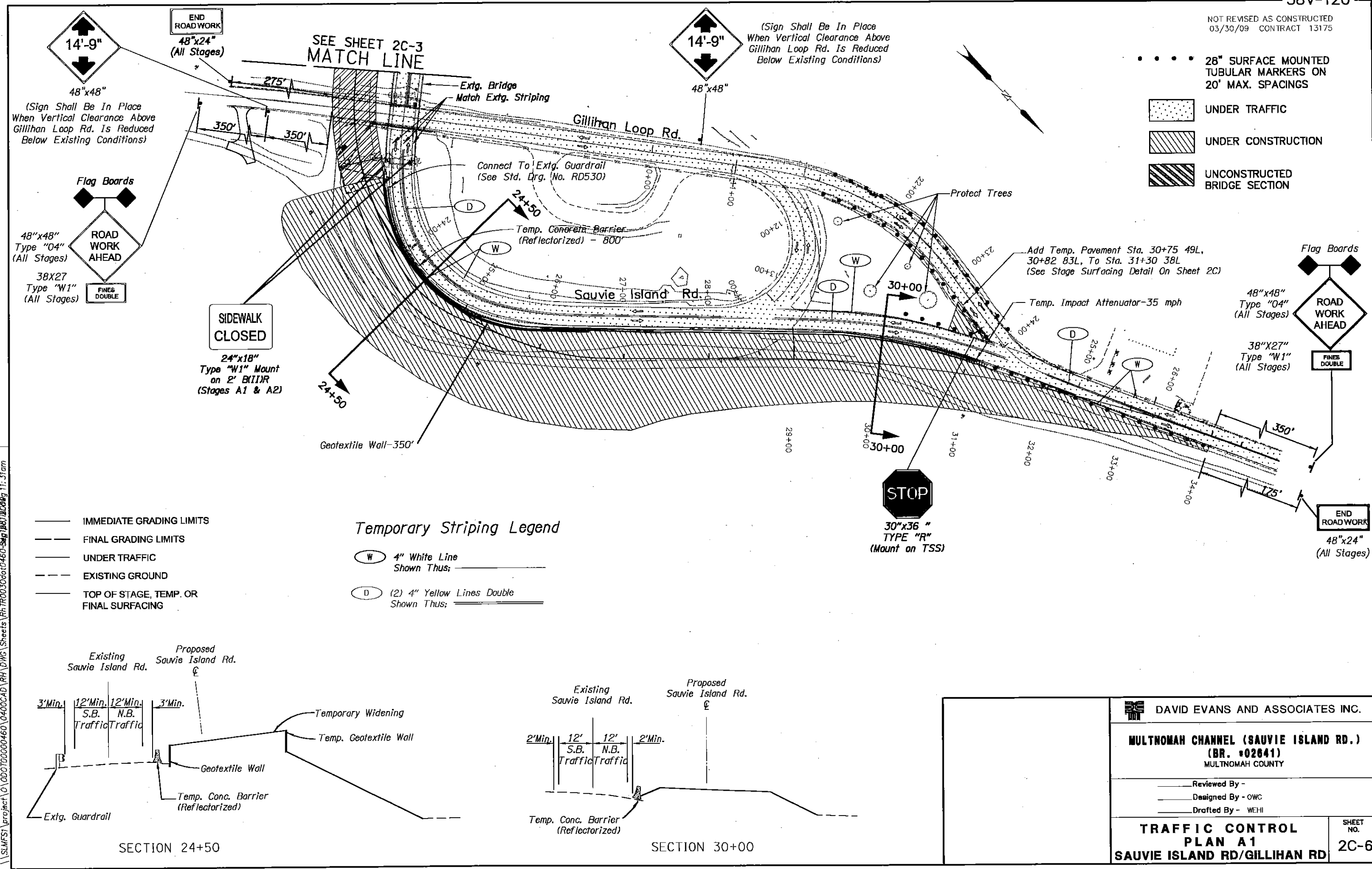

- 28" SURFACE MOUNTED TUBULAR MARKERS ON 20' MAX. SPACINGS
- [Pattern] UNDER TRAFFIC
- [Pattern] UNDER CONSTRUCTION
- [Pattern] UNCONSTRUCTED BRIDGE SECTION

- 14'-9" 48"x48" (Sign Shall Be In Place When Vertical Clearance Above Gillihan Loop Rd. Is Reduced Below Existing Conditions)
- END ROADWORK 48"x24" (All Stages)
- Flag Boards
- 48"x48" Type "O4" (All Stages)
- 38X27 Type "W1" (All Stages)
- FINES DOUBLE
- SIDWALK CLOSED 24"x18" Type "W1" Mount on 2" BIIIJR (Stages A1 & A2)

- Flag Boards
- 48"x48" Type "O4" (All Stages)
- 38"x27" Type "W1" (All Stages)
- FINES DOUBLE
- ROAD WORK AHEAD
- END ROADWORK 48"x24" (All Stages)

- IMMEDIATE GRADING LIMITS
- FINAL GRADING LIMITS
- UNDER TRAFFIC
- - - EXISTING GROUND
- TOP OF STAGE, TEMP. OR FINAL SURFACING

- ### Temporary Striping Legend
- (W) 4" White Line  
Shown Thus: \_\_\_\_\_
  - (D) (2) 4" Yellow Lines Double  
Shown Thus: \_\_\_\_\_

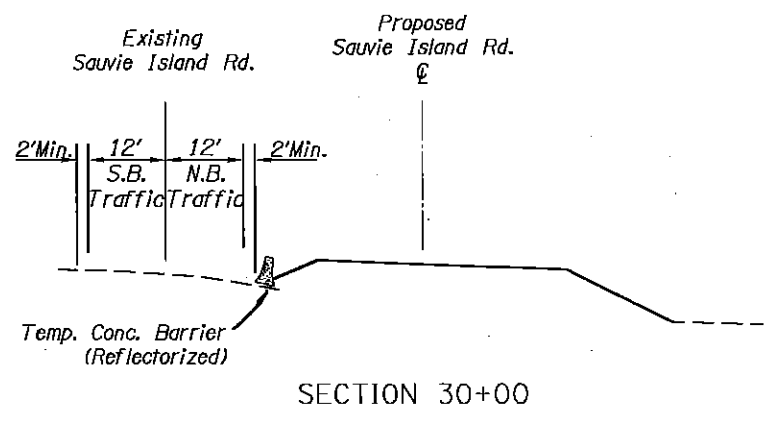
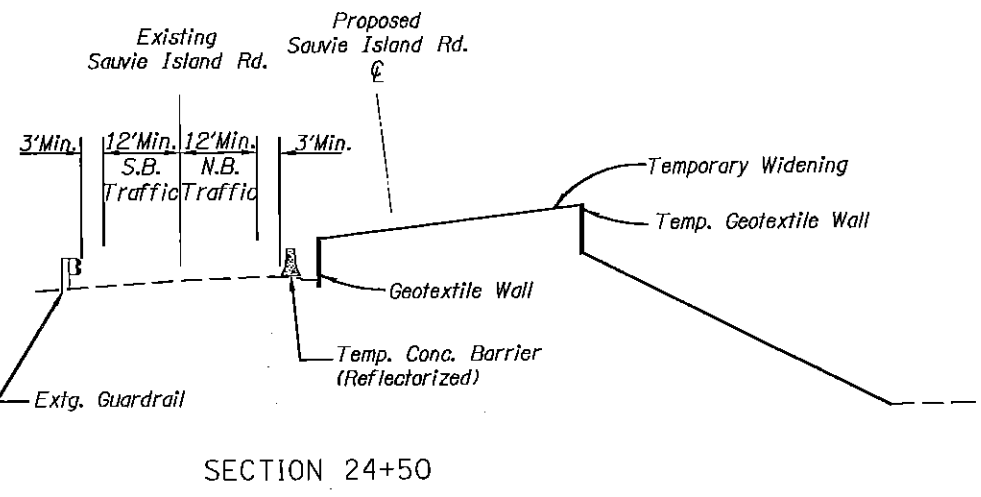

**DAVID EVANS AND ASSOCIATES INC.**

**MULTNOMAH CHANNEL (SAUVIE ISLAND RD.) (BR. #02641)**  
MULTNOMAH COUNTY

Reviewed By - \_\_\_\_\_  
 Designed By - OWC  
 Drafted By - WEHI

**TRAFFIC CONTROL PLAN A1 SAUVIE ISLAND RD/GILLIHAN RD**

SHEET NO. **2C-6**

S:\MFS1\project\000700000460\0400CAD\PH.DWG\Sheets\PH.TR0030000460-Sig\188188.dwg 11:31am

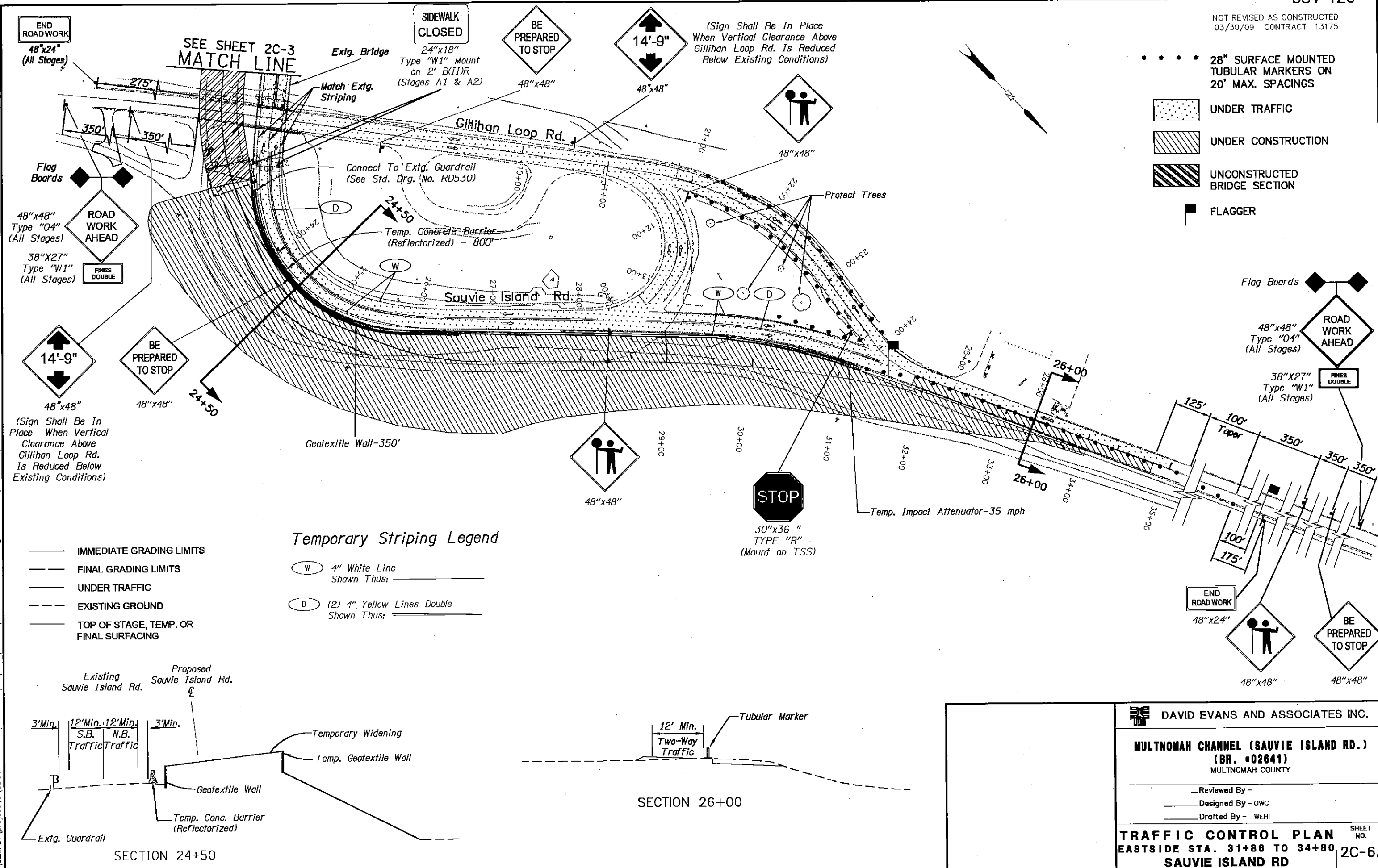

- 28" SURFACE MOUNTED TUBULAR MARKERS ON 20' MAX. SPACINGS
- UNDER TRAFFIC
- UNDER CONSTRUCTION
- UNCONSTRUCTED BRIDGE SECTION
- FLAGGER

**END ROAD WORK**  
48"x24"  
(All Stages)

**ROAD WORK AHEAD**  
48"x48"  
Type "O4"  
(All Stages)

38"x27"  
Type "W1"  
(All Stages)

**BE PREPARED TO STOP**  
48"x48"

14'-9"  
48"x48"

(Sign Shall Be In Place When Vertical Clearance Above Gillihan Loop Rd. Is Reduced Below Existing Conditions)

**SIDEWALK CLOSED**  
24"x18"  
Type "W1" Mount on 2' B(I)R  
(Stages A1 & A2)

**BE PREPARED TO STOP**  
48"x48"

14'-9"  
48"x48"

(Sign Shall Be In Place When Vertical Clearance Above Gillihan Loop Rd. Is Reduced Below Existing Conditions)

**ROAD WORK AHEAD**  
48"x48"  
Type "O4"  
(All Stages)

38"x27"  
Type "W1"  
(All Stages)

**BE PREPARED TO STOP**  
48"x48"

**STOP**  
30"x36"  
TYPE "R"  
(Mount on TSS)

**Temporary Striping Legend**

- W 4" White Line  
Shown Thus:
- D (2) 4" Yellow Lines Double  
Shown Thus:

- IMMEDIATE GRADING LIMITS
- FINAL GRADING LIMITS
- UNDER TRAFFIC
- EXISTING GROUND
- TOP OF STAGE, TEMP. OR FINAL SURFACING

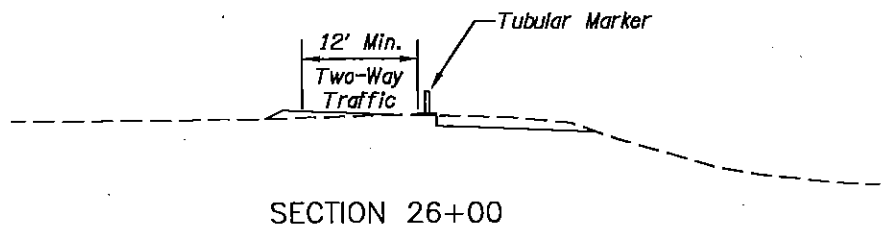
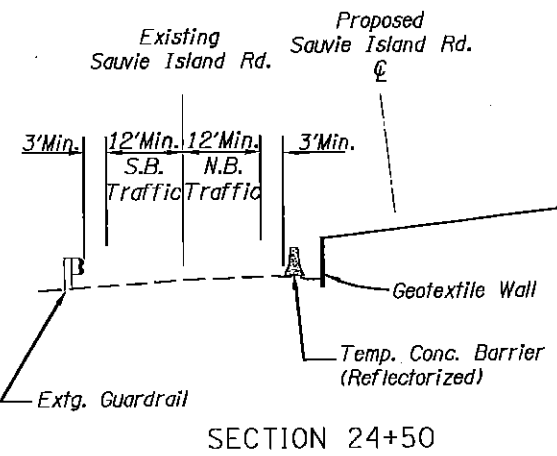

**DAVID EVANS AND ASSOCIATES INC.**

**MULTNOMAH CHANNEL (SAUVIE ISLAND RD.)**  
(BR. #02641)  
MULTNOMAH COUNTY

Reviewed By - \_\_\_\_\_  
Designed By - OWC  
Drafted By - WEHI

**TRAFFIC CONTROL PLAN**  
EASTSIDE STA. 31+86 TO 34+80  
SAUVIE ISLAND RD

SHEET NO. **2C-6A**

I:\SLMFS1\project\1\000T0000\460\4000CAD\PH\DWG\Sheets\PH\TR0030\0460-Sub\B1\B0000.dwg: 31am

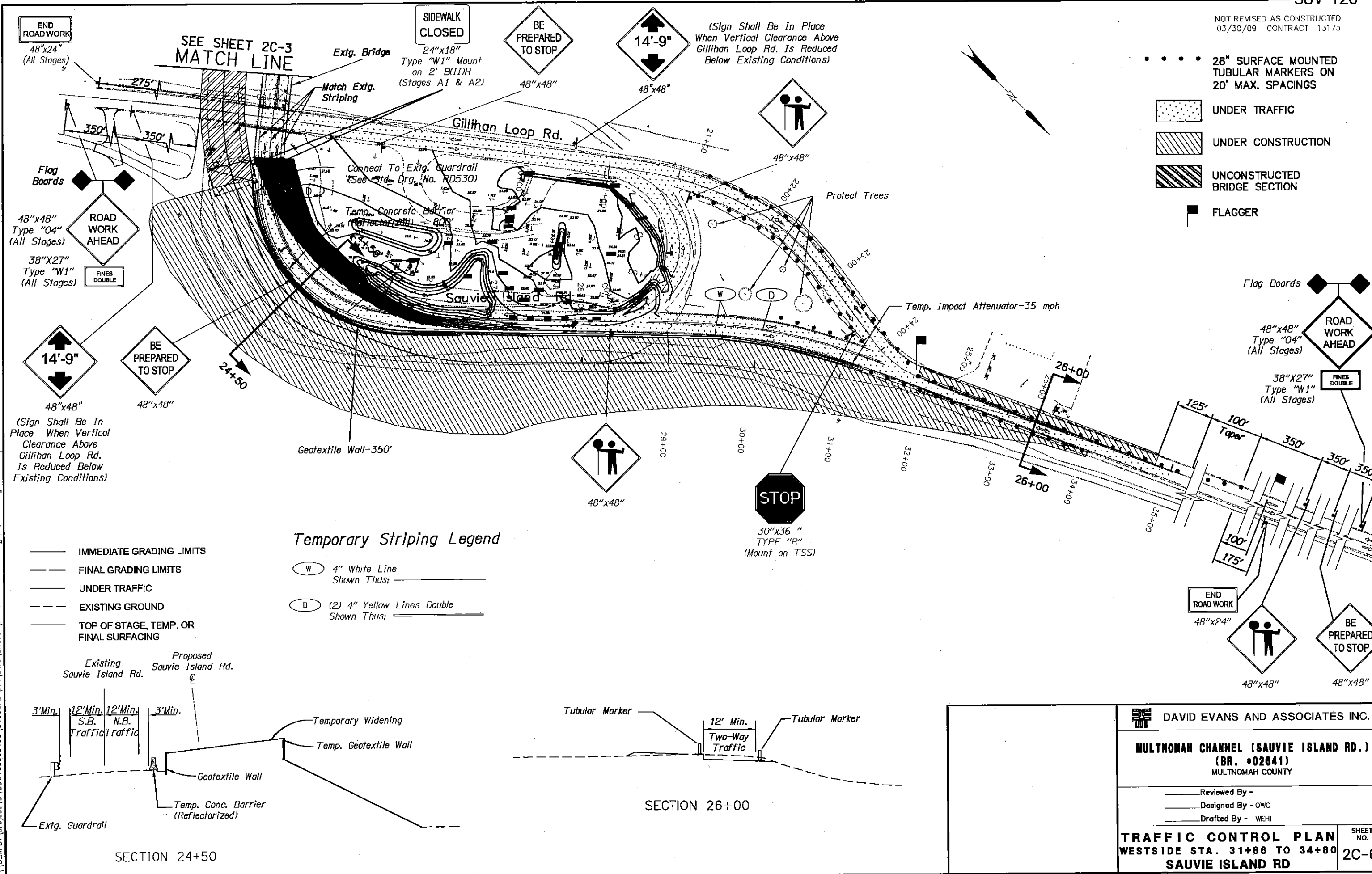

**END ROAD WORK**  
48"x24"  
(All Stages)

SEE SHEET 2C-3  
**MATCH LINE**

**SIDEWALK CLOSED**  
24"x18"  
Type "W1" Mount  
on 2" B(I)R  
(Stages A1 & A2)

**BE PREPARED TO STOP**  
48"x48"

**14'-9"**  
48"x48"

(Sign Shall Be In Place  
When Vertical Clearance Above  
Gillihan Loop Rd. Is Reduced  
Below Existing Conditions)

- 28" SURFACE MOUNTED TUBULAR MARKERS ON 20' MAX. SPACINGS
- [Pattern] UNDER TRAFFIC
- [Pattern] UNDER CONSTRUCTION
- [Pattern] UNCONSTRUCTED BRIDGE SECTION
- FLAGGER

Flag Boards

48"x48"  
Type "04"  
(All Stages)

38"x27"  
Type "W1"  
(All Stages)

**14'-9"**  
48"x48"

**BE PREPARED TO STOP**  
48"x48"

(Sign Shall Be In  
Place When Vertical  
Clearance Above  
Gillihan Loop Rd.  
Is Reduced Below  
Existing Conditions)

Flag Boards

48"x48"  
Type "04"  
(All Stages)

38"x27"  
Type "W1"  
(All Stages)

**STOP**  
30"x36"  
TYPE "R"  
(Mount on TSS)

**END ROAD WORK**  
48"x24"

48"x48"

**BE PREPARED TO STOP**  
48"x48"

**Temporary Striping Legend**

- IMMEDIATE GRADING LIMITS
- FINAL GRADING LIMITS
- UNDER TRAFFIC
- EXISTING GROUND
- TOP OF STAGE, TEMP. OR FINAL SURFACING
- W 4" White Line  
Shown Thus: —
- D (2) 4" Yellow Lines Double  
Shown Thus: —

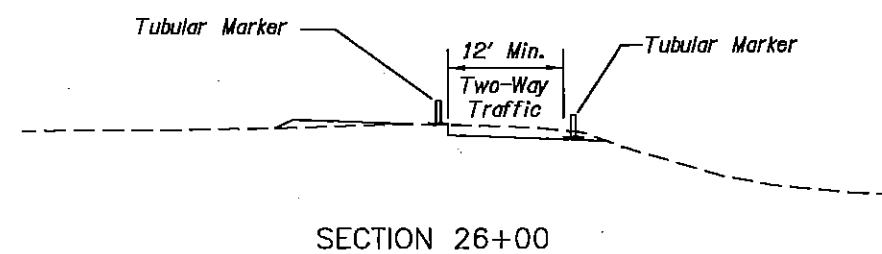
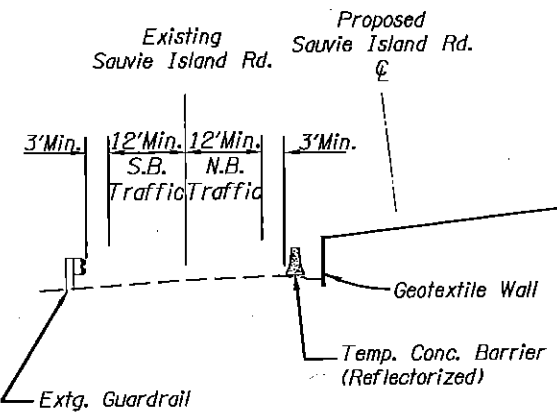

<b>MULTNOMAH CHANNEL (SAUVIE ISLAND RD.)</b> (BR. #02641) MULTNOMAH COUNTY	
Reviewed By -	Designed By - OWC
Drafted By - WEHI	
<b>TRAFFIC CONTROL PLAN</b> WESTSIDE STA. 31+86 TO 34+80 SAUVIE ISLAND RD	
SHEET NO.	2C-6B

I:\S\MFS1\project\0\000700000460\0400CAD\PH.DWG Sheets\PH.TFO030dot0460-54g\BCL\BCL.dwg: 31am

NOT REVISED AS CONSTRUCTED  
03/30/09 CONTRACT 13175

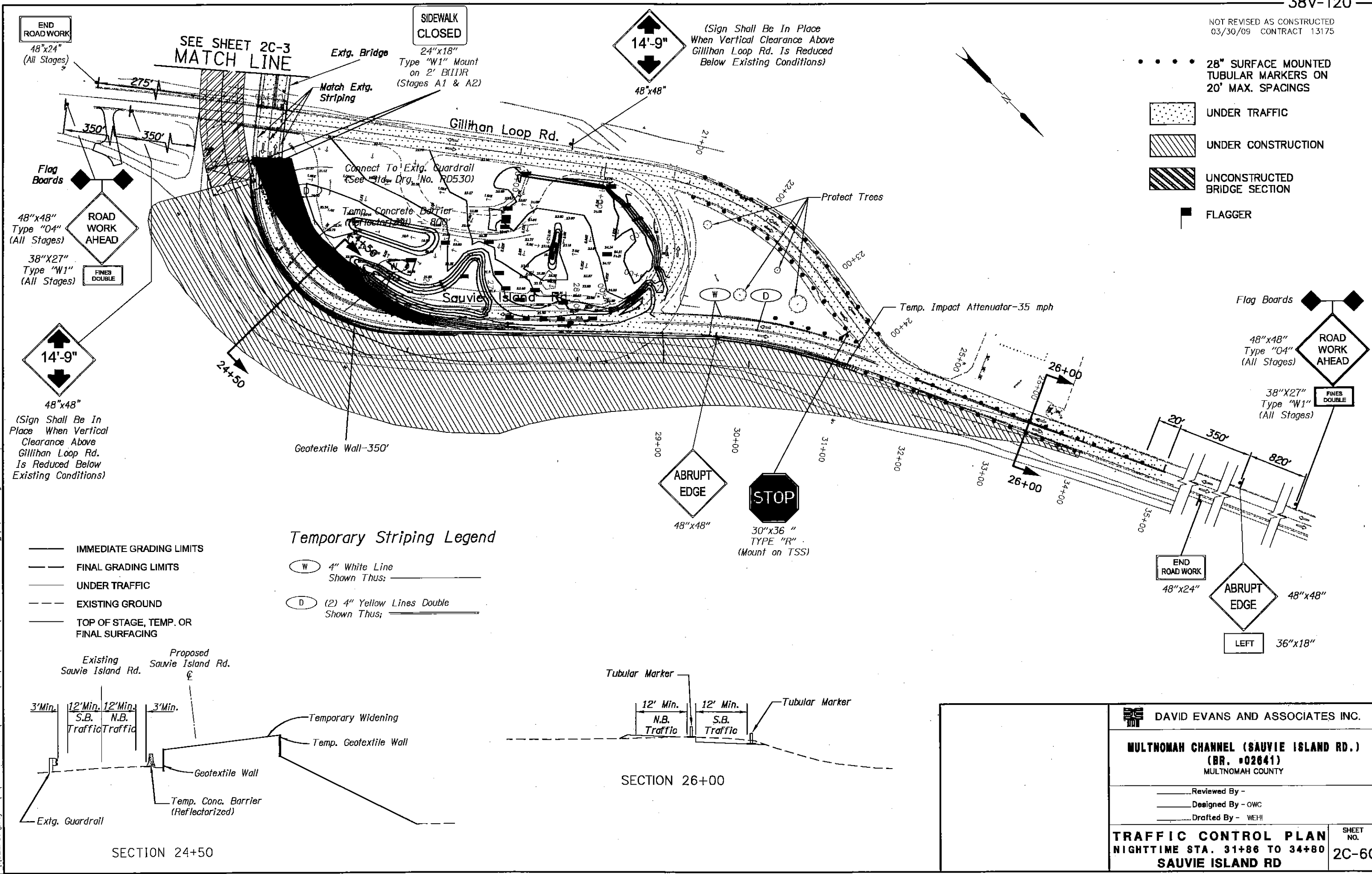

- 28" SURFACE MOUNTED TUBULAR MARKERS ON 20' MAX. SPACINGS
- [Pattern] UNDER TRAFFIC
- [Pattern] UNDER CONSTRUCTION
- [Pattern] UNCONSTRUCTED BRIDGE SECTION
- [Symbol] FLAGGER

**END ROAD WORK**  
48"x24"  
(All Stages)

**ROAD WORK AHEAD**  
48"x48"  
Type "O4"  
(All Stages)

38"x27"  
Type "W1"  
(All Stages)

**FINES DOUBLE**

14'-9"  
48"x48"  
(Sign Shall Be In Place When Vertical Clearance Above Gillihan Loop Rd. Is Reduced Below Existing Conditions)

**SIDEWALK CLOSED**  
24"x18"  
Type "W1" Mount on 2' BCIIR  
(Stages A1 & A2)

14'-9"  
48"x48"  
(Sign Shall Be In Place When Vertical Clearance Above Gillihan Loop Rd. Is Reduced Below Existing Conditions)

**Temporary Striping Legend**

- IMMEDIATE GRADING LIMITS
- FINAL GRADING LIMITS
- UNDER TRAFFIC
- EXISTING GROUND
- TOP OF STAGE, TEMP. OR FINAL SURFACING
- W 4" White Line  
Shown Thus: —
- D (2) 4" Yellow Lines Double  
Shown Thus: —

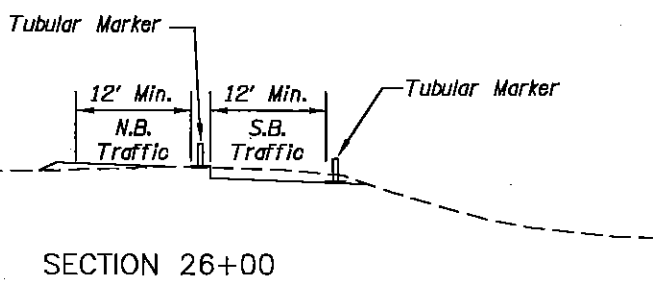
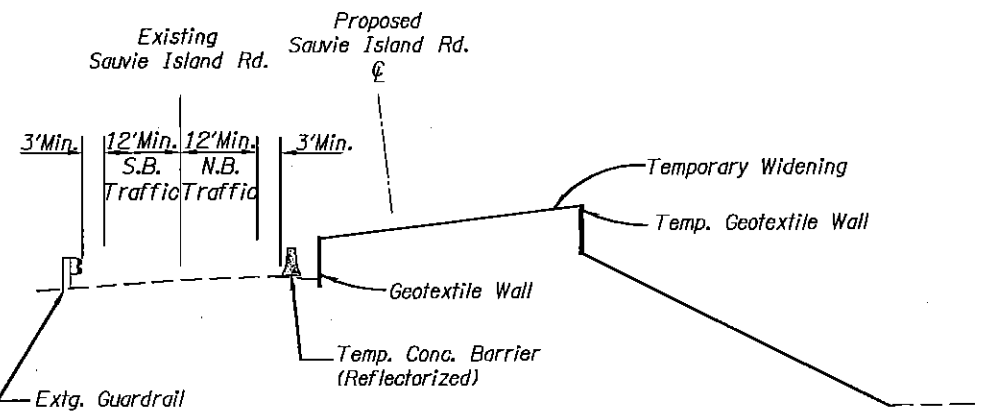

**DAVID EVANS AND ASSOCIATES INC.**

**MULTNOMAH CHANNEL (SAUVIE ISLAND RD.)**  
(BR. #02641)  
MULTNOMAH COUNTY





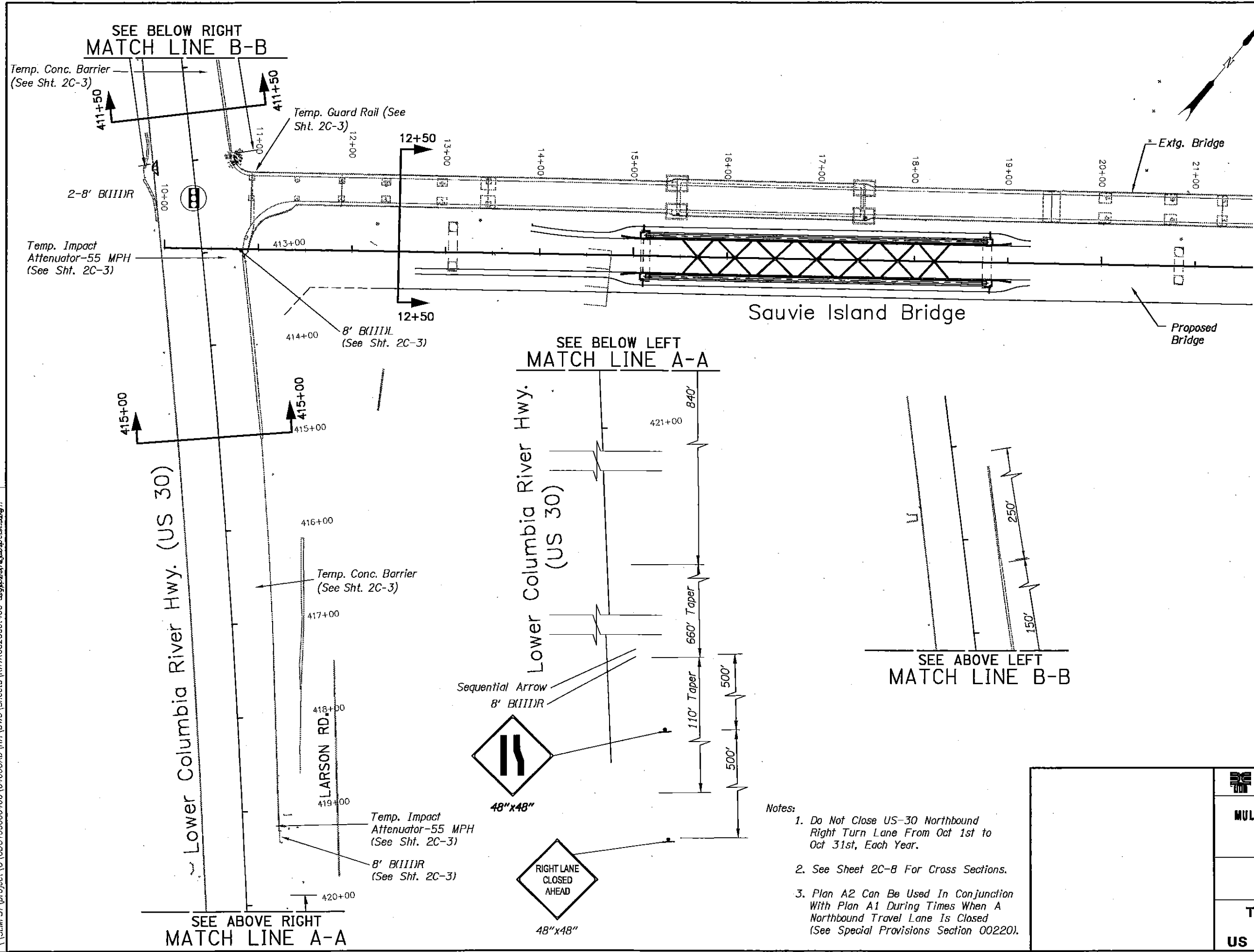

Reviewed By -  
Designed By - OWG  
Drafted By - WEH

**TRAFFIC CONTROL PLAN**  
NIGHTTIME STA. 31+86 TO 34+80  
SAUVIE ISLAND RD

SHEET NO.  
**2C-6C**

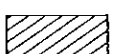
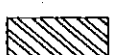
\\SLMFS1\project\04000000460\04000000460\CAD\PH\DWG\Sheets\PH\TR0030dat\0460-Sub\PH\BCD\0460.dwg - 31am



-  TEMPORARY SIGNAL
-  UNDER TRAFFIC
-  UNDER CONSTRUCTION
-  UNCONSTRUCTED BRIDGE SECTION
-  TEMP. PLASTIC DRUMS ON 10' MAX. SPACINGS
-  ALTERNATE TEMP. PLASTIC DRUMS AND 28" TUBULAR MARKERS ON 20' MAX. SPACINGS
-  TEMP. PLASTIC DRUMS ON 40' MAX. SPACINGS
-  28" TUBULAR MARKERS ON 10' MAX. SPACINGS

SEE BELOW LEFT  
MATCH LINE A-A

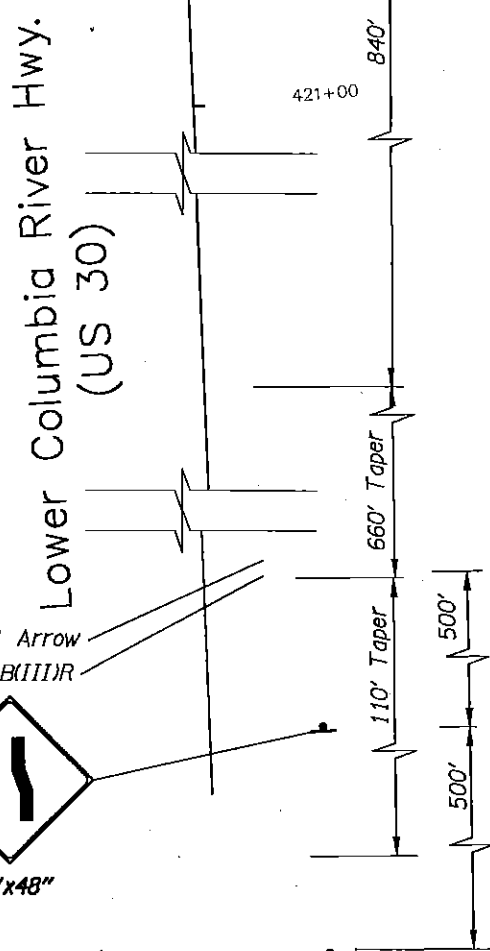

SEE ABOVE LEFT  
MATCH LINE B-B

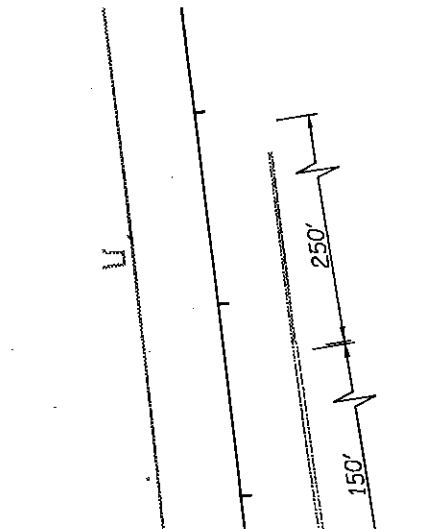

- Notes:
- Do Not Close US-30 Northbound Right Turn Lane From Oct 1st to Oct 31st, Each Year.
  - See Sheet 2C-8 For Cross Sections.
  - Plan A2 Can Be Used In Conjunction With Plan A1 During Times When A Northbound Travel Lane Is Closed (See Special Provisions Section 00220).

\\slmfs1\project\0\000700000460\0400CAD\RH\DWG\Sheets\RHTR0020dot460-sfgp\B01\000p.ctb.28grn

 DAVID EVANS AND ASSOCIATES INC.	
<b>MULTNOMAH CHANNEL (SAUVIE ISLAND RD.)</b> (BR. #02841) MULTNOMAH COUNTY	
Reviewed By - _____ Designed By - OWC Drafted By - WEHI	
<b>TRAFFIC CONTROL</b> <b>PLAN A2</b> <b>US 30/SAUVIE ISLAND RD.</b>	SHEET NO. <b>2C-7</b>



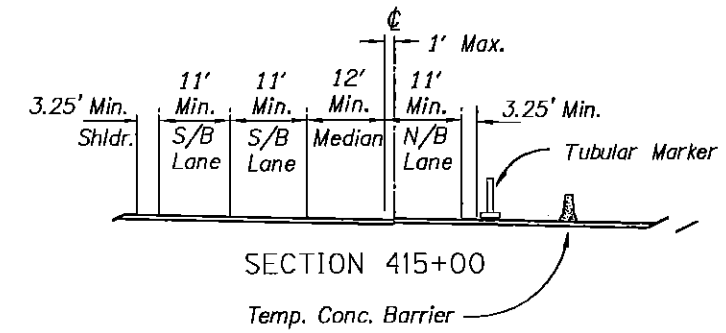
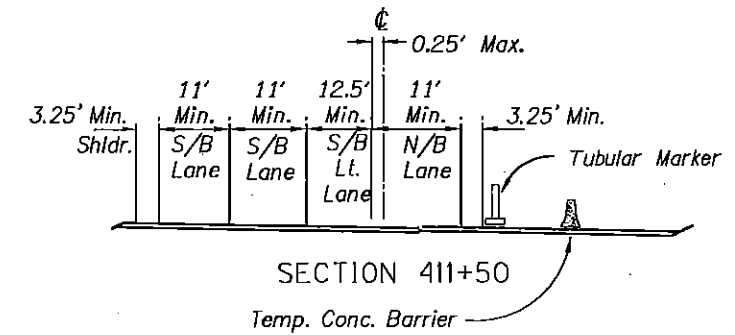
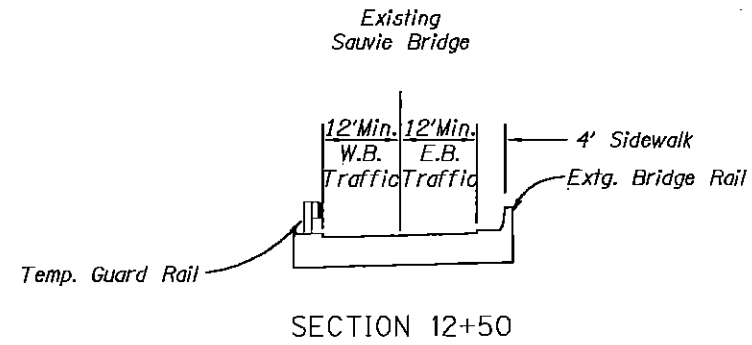

Notes:  
1. See Sheet 2C-7 For Plan View

\\SLMFS1\project\0\000T00000460\0400CAD\RH\DWG\Sheets\Rh TR0020dot460-sig\p\Bh\000p\ek\36am.dwg

		DAVID EVANS AND ASSOCIATES INC.	
		MULTNOMAH CHANNEL (SAUVIE ISLAND RD.) (BR. #02641) MULTNOMAH COUNTY	
Reviewed By - _____ Designed By - OWC Drafted By - WEHI		SHEET NO. 2C-8	
TRAFFIC CONTROL PLAN A2 US 30/SAUVIE ISLAND RD. SECTIONS			

Lower Columbia River Hwy.  
(US 30)

### Temporary Striping Legend

- (D) 2 - 4" Yellow Lines Double  
Shown Thus:
- (S) Stop Line  
Shown Thus:

TEMPORARY SIGNAL

UNDER TRAFFIC

UNDER CONSTRUCTION

..... TEMP. PLASTIC DRUMS ON 10' MAX. SPACINGS

o o o o TEMP. PLASTIC DRUMS ON 20' MAX. SPACINGS

• • • • 28" TUBULAR MARKERS ON 40' MAX. SPACINGS

\* = Temp. Detour Bridge Width Is Only Approximate. Actual Bridge Width Shall Be Determined By The Contractor And As Approved By The Engineer. See Special Provision Section 00252.

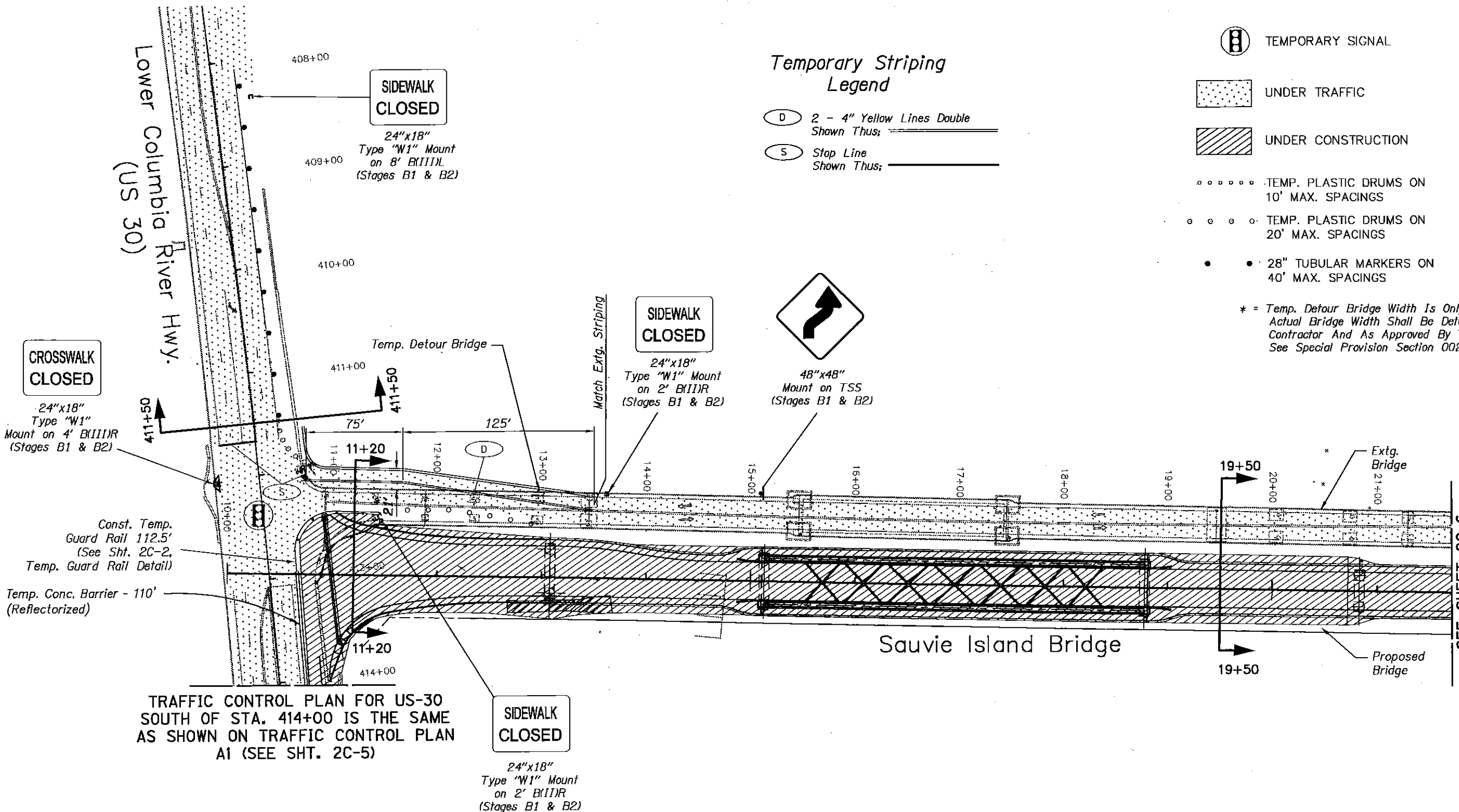
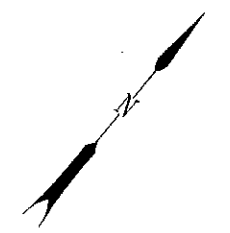

- Notes:
1. Do Not Close US-30 Northbound Right Turn Lane From Oct 1st to Oct 31st, Each Year.
  2. See Sheet 2C-10 For Cross Sections.
  3. See Temp. Traffic Signal Plan Dwg Nos. 13928 & 13929.
  4. Adjust Angle Of Barricades On Sidewalk, With Less Than 4' Sidewalk Width, As Needed To Keep Barricades Out Of Roadway.

DAVID EVANS AND ASSOCIATES INC.	
<b>MULTNOMAH CHANNEL (SAUVIE ISLAND RD.)</b> (BR. #02641) MULTNOMAH COUNTY	
Reviewed By - _____ Designed By - OWC Drafted By - WEHI	
<b>TRAFFIC CONTROL PLAN B1</b> <b>US 30/SAUVIE ISLAND RD.</b>	SHEET NO. <b>2C-9</b>

\\SLMFS1\project\0\CDOT\00000460\0400CAD\RH\DWG\Sheets\PH\TR0040dat\0460-Sig\2C2000.dwg: 32am

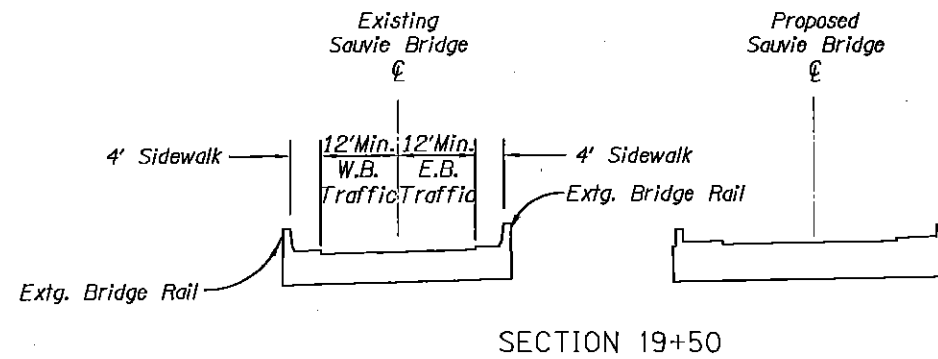
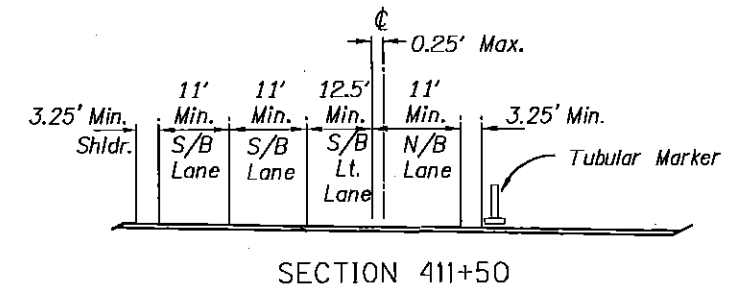
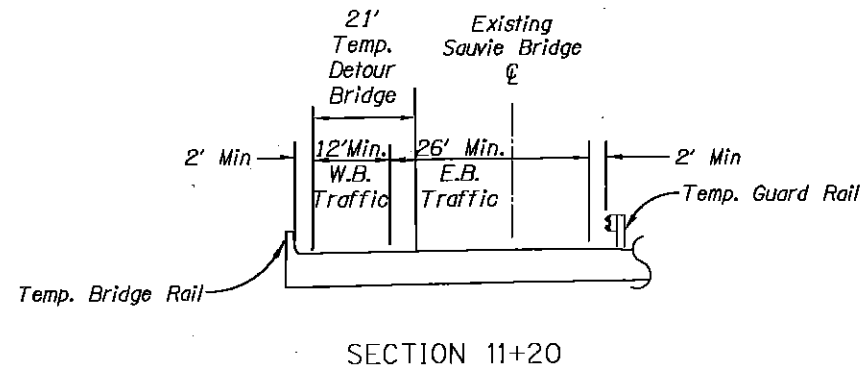

Note:  
1. See Sheet 2C-9 For The Plan View

\\S:\MFS1\project\000100000460\04000460\04000460\DWG\Sheets\Rh\TR0020dot460-sfgp\B8h.g00sect1.dwg.am

	DAVID EVANS AND ASSOCIATES INC.	
	MULTNOMAH CHANNEL (SAUVIE ISLAND RD.) (BR. #02641) MULTNOMAH COUNTY	
	Reviewed By - _____ Designed By - OWC Drafted By - WEHI	
	<b>TRAFFIC CONTROL PLAN B1</b>	
US 30/SAUVIE ISLAND RD. SECTIONS		SHEET NO. <b>2C-10</b>

SEE BELOW RIGHT  
MATCH LINE B-B

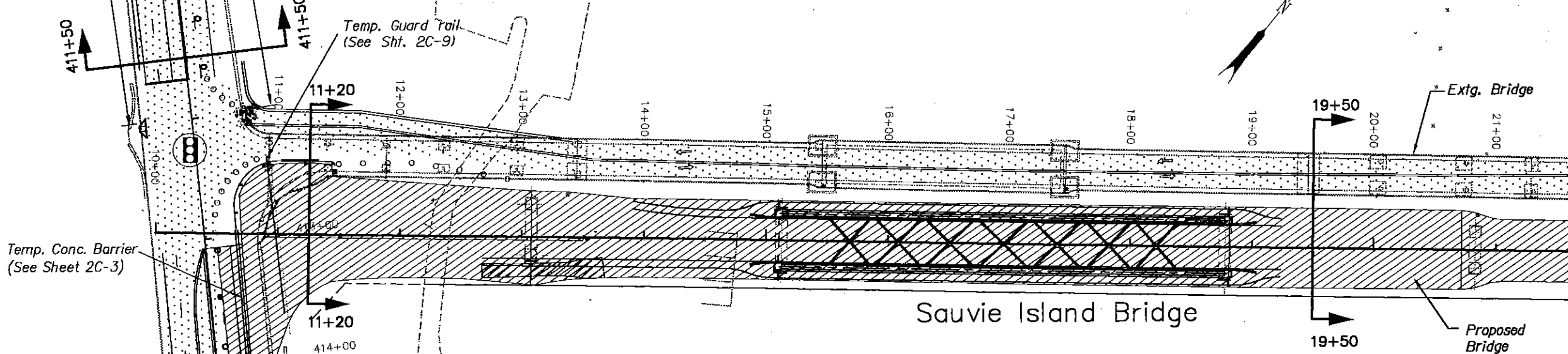

SEE BELOW LEFT  
MATCH LINE A-A

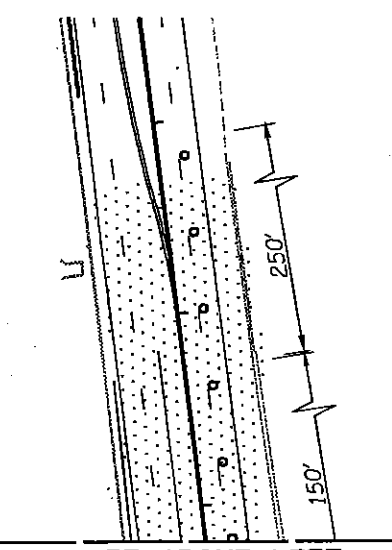
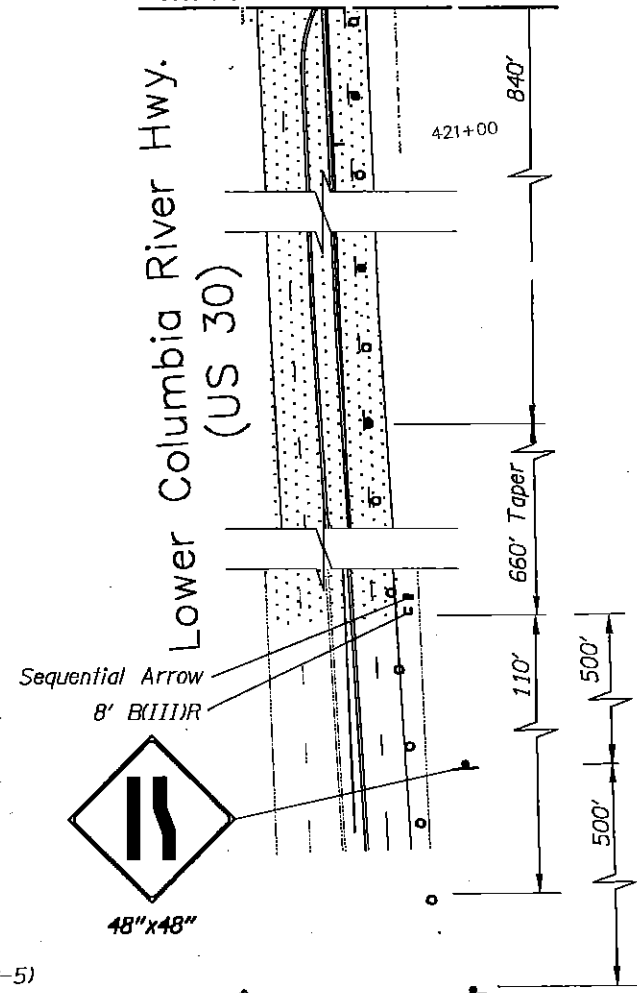

SEE ABOVE LEFT  
MATCH LINE B-B

- TEMPORARY SIGNAL
- UNDER TRAFFIC
- UNDER CONSTRUCTION
- TEMP. PLASTIC DRUMS ON 10' MAX. SPACINGS
- TEMP. PLASTIC DRUMS ON 10' MAX. SPACINGS
- TEMP. PLASTIC DRUMS ON 40' MAX. SPACINGS
- ALTERNATE TEMP. PLASTIC DRUMS AND 28" TUBULAR MARKERS ON 20' MAX. SPACINGS

- Notes:
- Do Not Close US-30 Northbound Right Turn Lane From Oct 1st to Oct 31st, Each Year.
  - See Sheet 2C-12 For Cross Sections.
  - Plan B2 Can Be Used In Conjunction With Plan B1 During Times When A Northbound Travel Lane Is Closed (See Special Provisions Section 00220).

DAVID EVANS AND ASSOCIATES INC.

MULTNOMAH CHANNEL (SAUVIE ISLAND RD.)  
(BR. #02841)  
MULTNOMAH COUNTY

Reviewed By -  
Designed By - OWC  
Drafted By - WEHI

TRAFFIC CONTROL  
PLAN B2  
US 30/SAUVIE ISLAND RD.

SHEET NO.  
2C-11

\\SLMFS1\project\0\000700000460\0400CAD\RH\DWG\Sheets\RH\TRC\40oct0460-Sig\1882809\trf\trf1a23.rtg

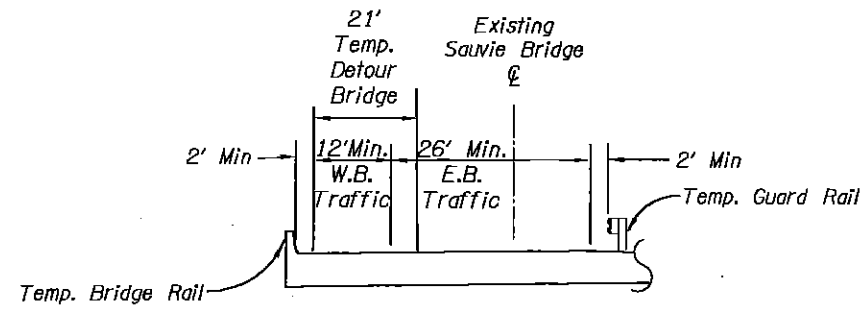

SECTION 11+20

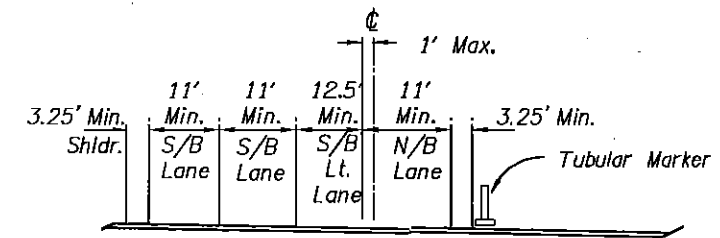

SECTION 411+50

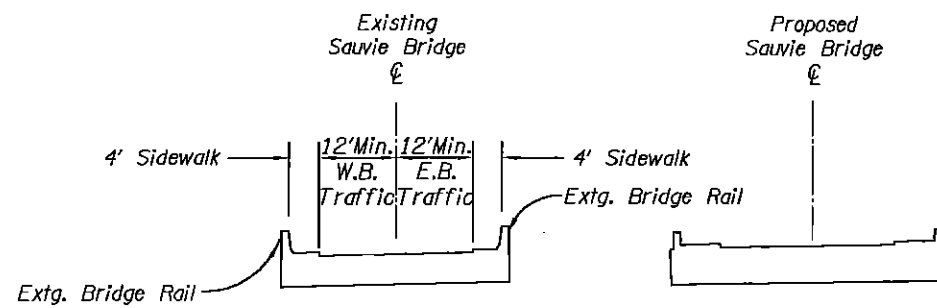

SECTION 19+50

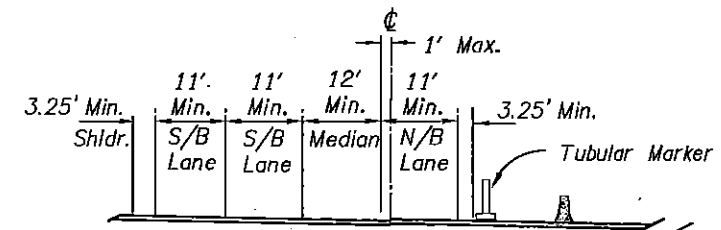

SECTION 415+00

Temp. Conc. Barrier

Notes:  
1. See Sheet 2C-12 For Plan View

\\SLMFS1\project\0\000T00000460\0400CAD\PH\DWG\Sheets\PH\TR0020\0460-s\slp\slp.dwg

 DAVID EVANS AND ASSOCIATES INC.	
MULTNOMAH CHANNEL (SAUVIE ISLAND RD.) (BR. #02641) MULTNOMAH COUNTY	
Reviewed By - _____ Designed By - OWC Drafted By - WEHI	
TRAFFIC CONTROL PLAN B2 US 30/SAUVIE ISLAND RD. SECTIONS	SHEET NO. 2C-12

