

PHILLIPSTON ROUTE 2 OVER ROUTE 2A			
STATE	FED. AID PROJ. NO.	SHEET NO.	TOTAL SHEETS
MASS.		37	76
PROJECT FILE NO. 603495			
CONSTRUCTION DETAILS			

SUGGESTED CONSTRUCTION SEQUENCE:

1. PREPARE FOUNDATION FOR TEMPORARY FALSEWORK.
2. ERECT TEMPORARY FALSEWORK.
3. CONSTRUCT PROPOSED BRIDGE ON TEMPORARY FALSEWORK.
4. DEMOLISH/REMOVE EXISTING SUPERSTRUCTURE.
5. DEMOLISH/REMOVE TOP PORTIONS OF EXISTING ABUTMENTS.
6. PLACE PROPOSED PRECAST ABUTMENT CAPS ON EXISTING ABUTMENTS AND GROUT INTO PLACE.
7. DRILL AND INSTALL GROUTED DOWELS THROUGH ABUTMENT CAP INTO EXISTING ABUTMENT.
8. PREPARE GANTRY TRACK FOUNDATION AND SET TRACK.
9. PLACE GANTRIES ON TRACK WITH HEADER BEAM UNDER PROPOSED BRIDGE.
10. REMOVE ALL SIGNIFICANT CONSTRUCTION LIVE LOAD OFF OF THE BRIDGE. THIS INCLUDES ANY EQUIPMENT, FORMING, ETC. ON TOP OF OR ATTACHED TO THE BRIDGE.
11. LIFT PROPOSED BRIDGE OFF TEMPORARY FALSEWORK.
12. MOVE BRIDGE ON GANTRIES SOUTH TO ABUTMENTS.
13. LOWER PROPOSED BRIDGE ONTO ABUTMENTS.
14. CONSTRUCT CAST-IN-PLACE CURTAIN WALLS.

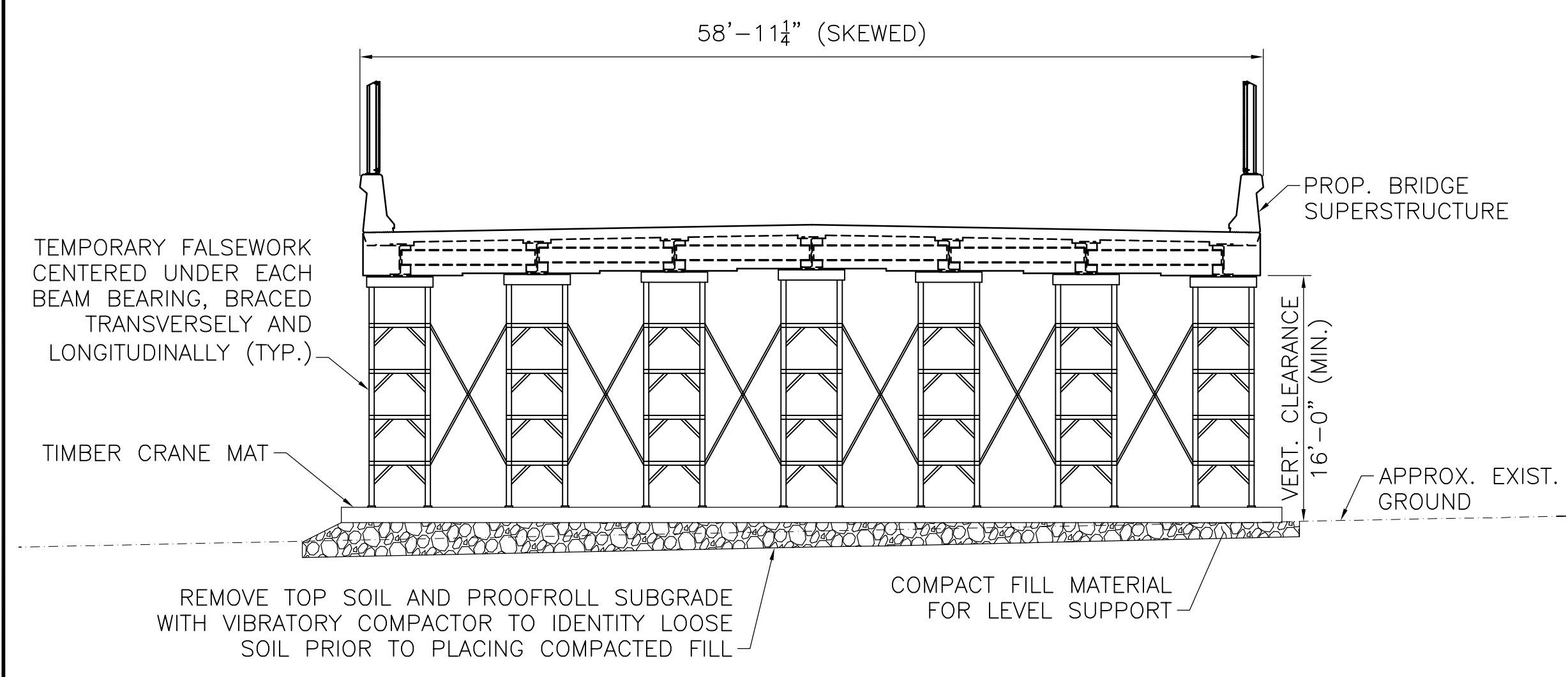

TEMPORARY FALSEWORK ELEVATION
SCALE: 1/8" = 1'-0"

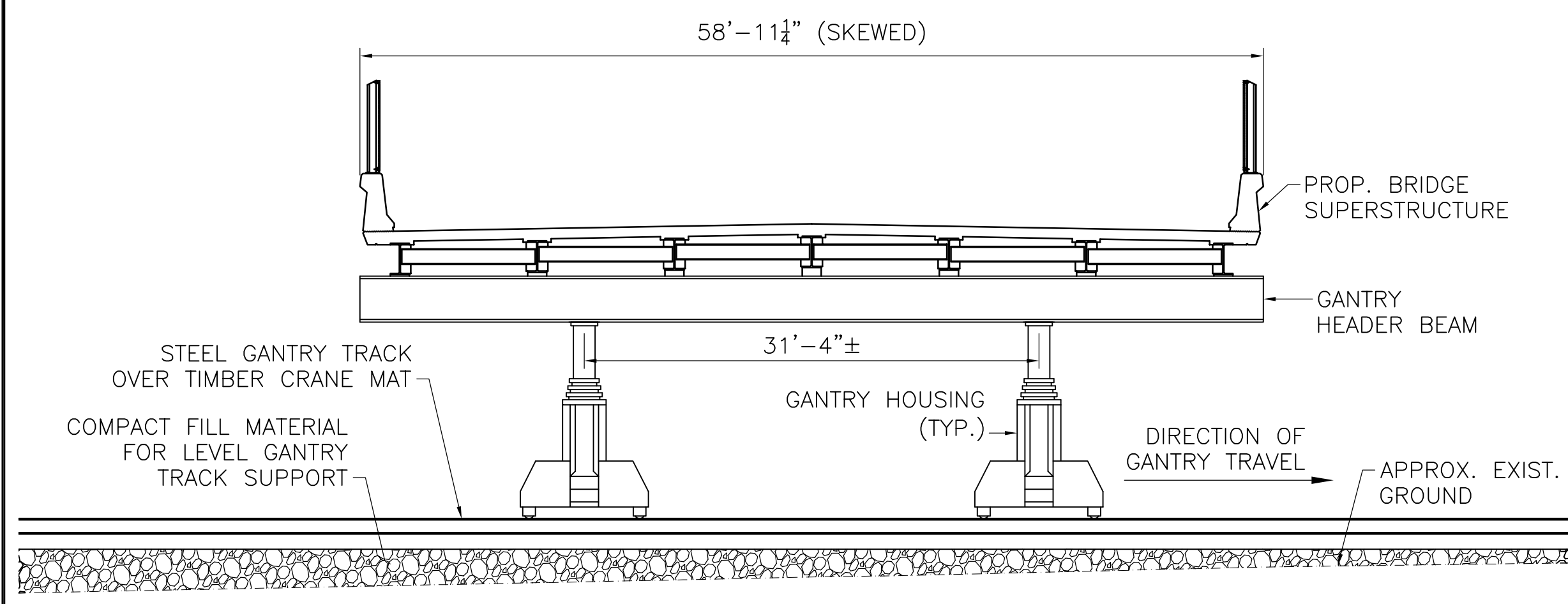

TRANSVERSE SECTION
SCALE: 1/8" = 1'-0"

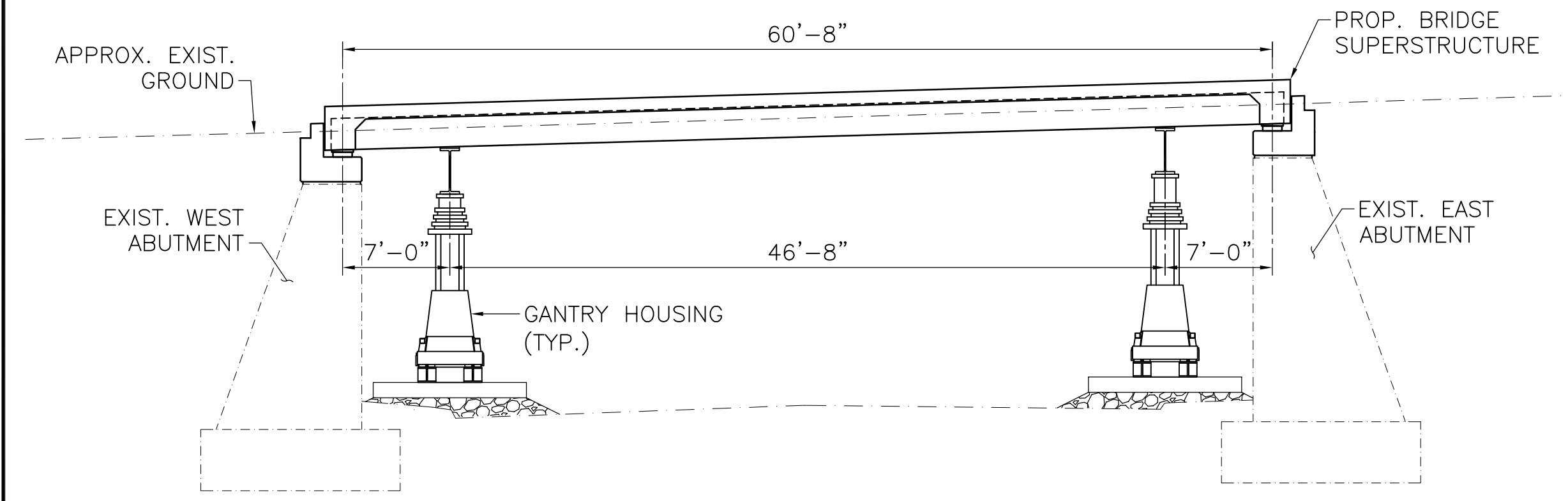

LONGITUDINAL SECTION
SCALE: 1/8" = 1'-0"

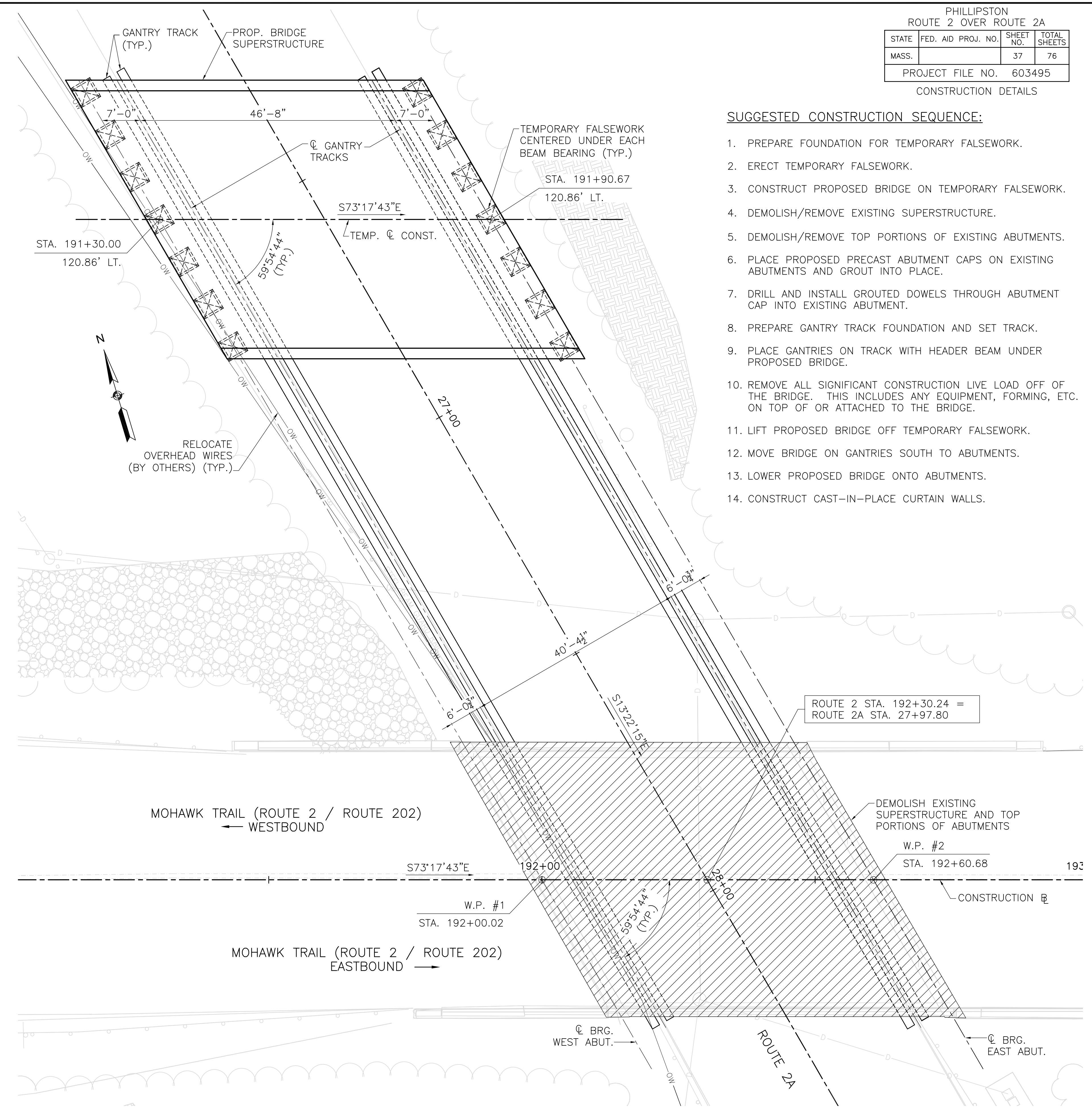

CONSTRUCTION PLAN
SCALE: 1" = 10'

ISSUED FOR CONSTRUCTION	
DATE	DESCRIPTION
	USE ONLY PRINTS OF LATEST DATE

C:\Active Projects\0181\Bridge\PhilBR158.dwg, Plotted: Oct 11, 2010 - 9:12pm