

DEPARTMENT OF TRANSPORTATION STATE OF GEORGIA

COSTING PLANS FOR PLAN AND PROFILE OF PROPOSED I-85 INTERCHANGE AT CR 98 / GABBETTVILLE ROAD CSNHS-0008-00(232) TROUP COUNTY

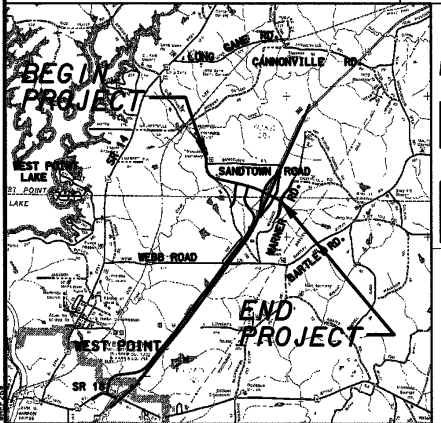

LOCATION SKETCH

NOTE: THE CO-ORDINATES LISTED ARE WEST ZONE GRID CO-ORDINATES BASED ON THE GA. STATE PLANE CO-ORDINATE SYSTEM OF:
HORIZONTAL DATUM: NAD 83/94
VERTICAL DATUM: NAVD 88

MIDPOINT COORDINATE

STATION	142+26.40
N	1067272.7619
E	2004811.8969

FEDERAL AID PROJECT

Georgia D.O.T. P.I. No. 0008232
FEDERAL ROUTE No. N/A
STATE ROUTE No. N/A

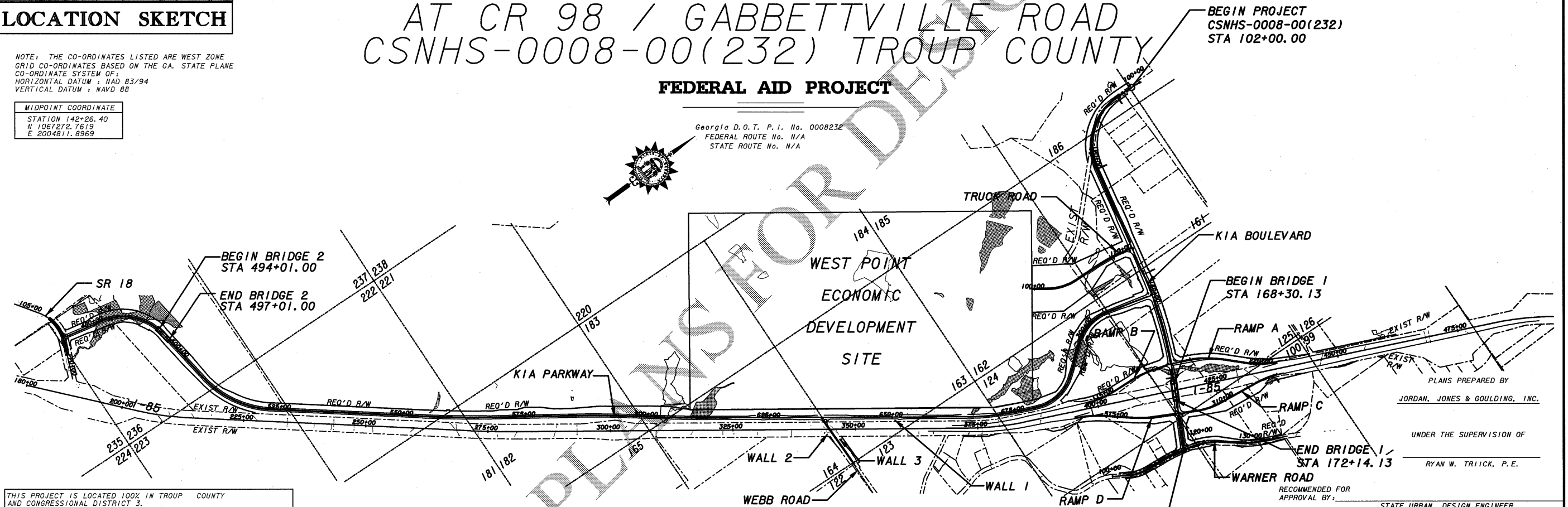

THIS PROJECT IS LOCATED 100% IN TROUP COUNTY AND CONGRESSIONAL DISTRICT 3.
PROJECT DESIGNATION: FULL OVERSIGHT
PDP CLASSIFICATION: MAJOR
FUNCTIONAL CLASSIFICATION: LOCAL COLLECTOR (KIA BLVD) LOCAL ROAD (KIA PKWY)

NOTE: THESE PLANS ARE IN ENGLISH UNITS

NOTES:
ALL REFERENCES IN THIS DOCUMENT, WHICH INCLUDES ALL PAPERS, WRITINGS, DOCUMENTS, DRAWINGS OR PHOTOGRAPHS USED, OR TO BE USED IN CONNECTION WITH THIS DOCUMENT, TO "STATE HIGHWAY DEPARTMENT OF GEORGIA", "STATE HIGHWAY DEPARTMENT", "GEORGIA STATE HIGHWAY DEPARTMENT", "HIGHWAY DEPARTMENT", OR "DEPARTMENT" WHEN THE CONTEXT THEREOF MEANS THE STATE HIGHWAY DEPARTMENT OF GEORGIA MEAN, AND SHALL BE DEEMED TO MEAN THE DEPARTMENT OF TRANSPORTATION.

THE DATA, TOGETHER WITH ALL OTHER INFORMATION SHOWN ON THESE PLANS, OR IN ANY WAY INDICATED THEREBY, WHETHER BY DRAWINGS OR NOTES, OR IN ANY OTHER MANNER, ARE BASED UPON FIELD INVESTIGATIONS AND ARE BELIEVED TO BE INDICATIVE OF ACTUAL CONDITIONS. HOWEVER, THE SAME ARE SHOWN AS INFORMATION ONLY, ARE NOT GUARANTEED, AND DO NOT BIND THE DEPARTMENT OF TRANSPORTATION IN ANY WAY. THE ATTENTION OF THE BIDDER IS SPECIFICALLY DIRECTED TO ARTICLES 102.04, 102.05, AND 104.03 OF THE SPECIFICATIONS OF THE DEPARTMENT OF TRANSPORTATION, STATE OF GEORGIA, FOR THE CONSTRUCTION OF TRANSPORTATION SYSTEMS, CURRENT EDITION, AND ANY MODIFICATIONS THEREOF, WHICH WILL BE A PART OF THIS CONTRACT.

ALL WORK TO BE DONE IN ACCORDANCE WITH THE SPECIFICATIONS OF THE DEPARTMENT OF TRANSPORTATION OF GEORGIA, CURRENT EDITION, AS APPROVED BY THE FEDERAL HIGHWAY ADMINISTRATION.



COUNTY NO. 285	KIA BLVD	KIA PKWY
LENGTH OF PROJECT		
PI NO 0008232-TROUP COUNTY	MILES	MILES
NET LENGTH OF ROADWAY	1.452	4.526
NET LENGTH OF BRIDGES	0.073	0.057
NET LENGTH OF PROJECT	1.525	4.583
NET LENGTH OF EXCEPTIONS	0.000	0.000
GROSS LENGTH OF PROJECT	1.525	4.583

DESIGN DATA	KIA BLVD	KIA PKWY
TRAFFIC A.D.T.:	14,200 (2009)	14,000 (2009)
TRAFFIC A.D.T.:	27,900 (2029)	20,300 (2029)
TRAFFIC D.H.V.:	3530 (2029)	2530 (2029)
DIRECTIONAL DIST.:	46%/54% WBEB	56%/44% SBNB
% TRUCKS:	8.0%	8.0%
% 24 HR. TRUCKS:	10.0%	10.0%
SPEED DESIGN:	45 MPH	45 MPH



PLANS PREPARED BY
JORDAN, JONES & GOULDING, INC.

UNDER THE SUPERVISION OF
RYAN W. TRIICK, P.E.

RECOMMENDED FOR APPROVAL BY: _____
STATE URBAN DESIGN ENGINEER

DATE _____ CHIEF ENGINEER

LOCATION AND DESIGN APPROVAL DATE: _____
PLANS COMPLETED DATE: FEBRUARY 19, 2007

REVISION DATES:

NO.	DATE	DESCRIPTION

STATE	PROJECT NUMBER	SHEET NO.	TOTAL SHEETS
GA.	CSNHS-0008-00(232)		

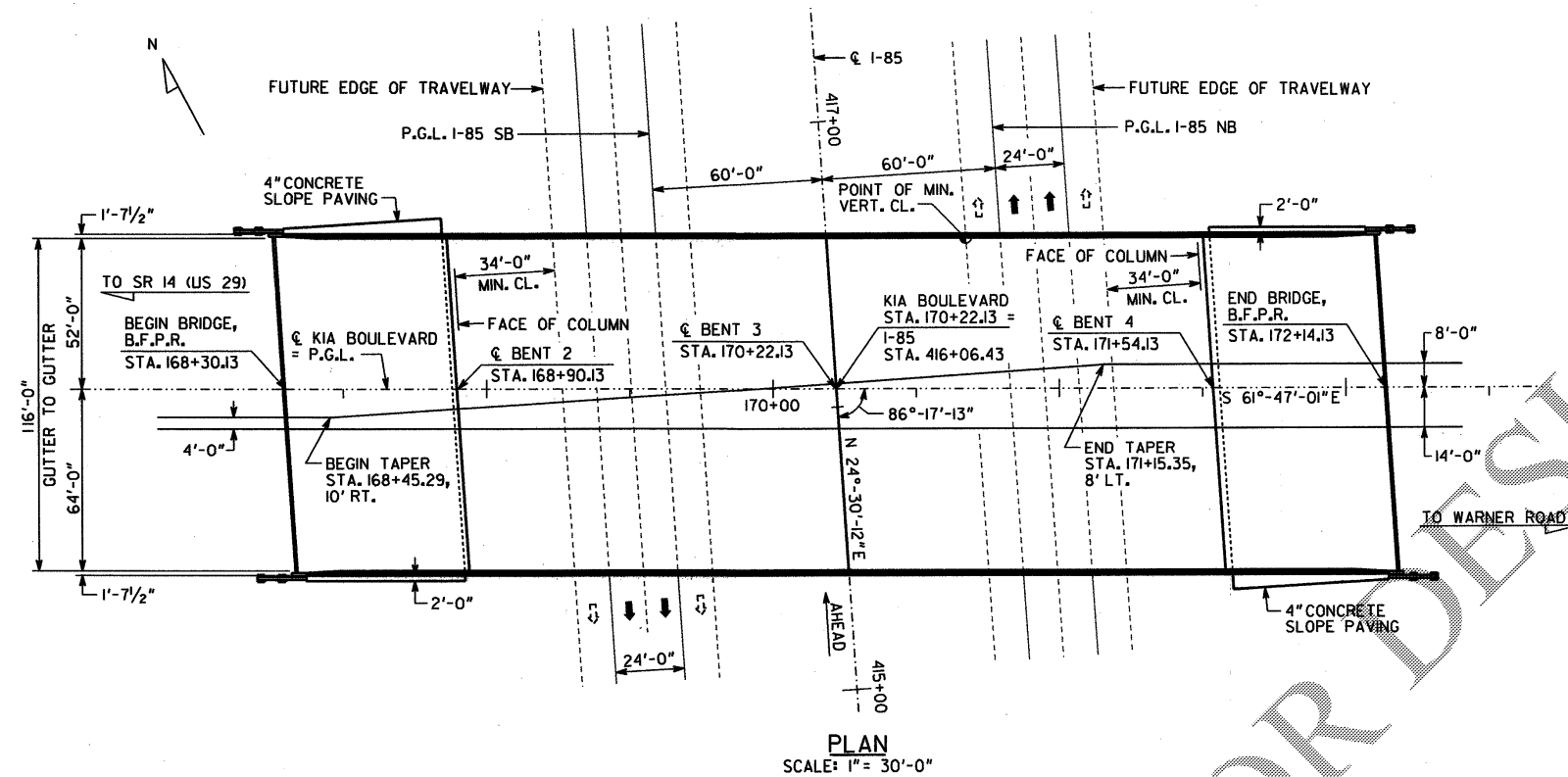

PROPOSED BRIDGE CONSISTS OF

- 2 - 132'-0" BULB TEE, 72 IN, PSC BEAM SPANS ----- SPECIAL DESIGN
- 2 - 60'-0" TYPE II PSC BEAM SPANS WITH 72 IN BULB TEE FASCIA --- SPECIAL DESIGN
- 2 - PILE END BENTS ----- SPECIAL DESIGN
- 3 - CONCRETE INTERMEDIATE BENTS ----- SPECIAL DESIGN

DESIGN DATA

SPECIFICATION ----- AASHTO 2002, 17TH EDITION
(DESIGNED FOR SEISMIC PERFORMANCE CATEGORY A)
TYPICAL HS20-44 AND/OR MILITARY LOADING ----- IMPACT ALLOWED
FUTURE PAVING ALLOWANCE ----- 30 LBS PER SQ FT

UTILITIES

TRAFFIC SIGNAL CONDUIT

TRAFFIC DATA

TRAFFIC ----- ADT = 8600 (2009)
ADT = 24000 (2029)
DESIGN SPEED ----- 45 MPH
TRUCKS ----- 6%
24 HR TRUCKS ----- 6%
DIRECTIONAL ----- 27/73

BENCHMARK

STA.: 178+96.00
OFFSET: 24' LT
ELEVATION: 659.36
N 1066208.93943
E 2007678.27466
DESCRIPTION: 60 PENNY NAIL FLUSH WITH GROUND

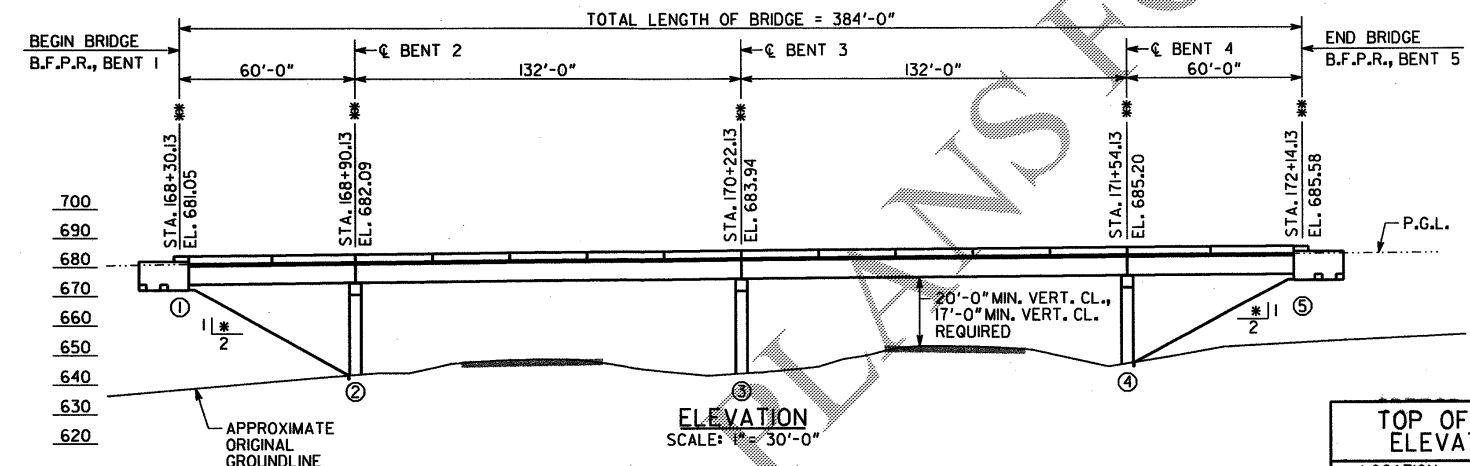

TOP OF BERM ELEVATIONS *	
LOCATION	ELEVATION
BENT 1, LEFT	670.65
BENT 1, RIGHT	670.58
BENT 5, LEFT	675.17
BENT 5, RIGHT	675.01

* FOR BRIDGE ENDROLL STAKING PURPOSES ONLY

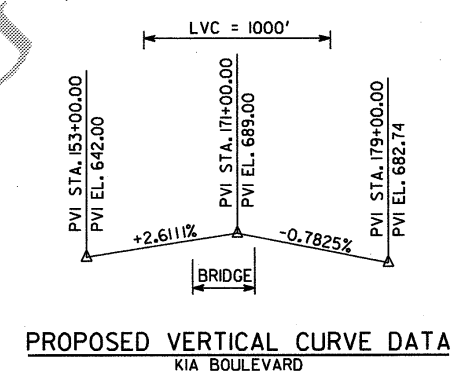
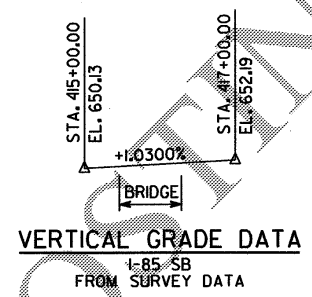
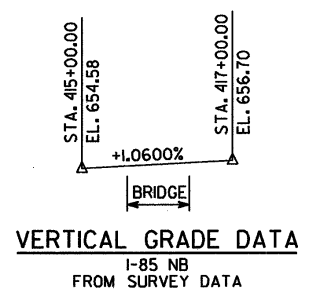

NOTES:

1. ** STATIONS AND ELEVATIONS ARE ALONG PROFILE GRADE LINE AT THE INTERSECTION OF PROFILE GRADE LINE AND B.F.P.R. OR C BENT.
2. * NORMAL TO END BENT.
3. ALL BENTS ARE PARALLEL.
4. THE PROPOSED BRIDGE DECK SHALL BE BUILT ON A NORMAL CROWN OF 2%.
5. INTERMEDIATE BENT CAPS AND COLUMNS TO BE PRECAST.
6. P.G.L. = PROFILE GRADE LINE.
7. DIRECTIONAL OVERHEAD SIGN STRAIN POLES MUST BE PLACED AT STATION 170+22.13 ON THE INTERMEDIATE BENT CAP. SEE SIGNING AND MARKING PLANS.

PROJECT P.I. NO. 0008232

BRIDGE NO. 1

GEORGIA
DEPARTMENT OF TRANSPORTATION
PRECONSTRUCTION DIVISION-OFFICE OF BRIDGE DESIGN

PRELIMINARY LAYOUT
CR 98 (KIA BOULEVARD) OVER I-85
TROUP COUNTY CSNHS-0008-00(232)

SCALE: 1" = 30'-0" FEBRUARY 2007



JORDAN JONES & GOULDING

NOT RELEASED FOR CONSTRUCTION

DATE	35.01
REVISIONS	
BY	

JOB NO. 2077-904	BRIDGE SHEET 1 OF 2	DESIGNED LSW	CHECKED RJS	DESIGN GROUP SWW	REVIEWED WMD	APPROVED PVL
---------------------	------------------------	-----------------	----------------	---------------------	-----------------	-----------------